

# IP-HD PTZ DOME CAMERA



## INSTRUCTION MANUAL

**IR MINI Dome** VIDEO SECURITY SYSTEMS

## **SAFETY INSTRUCTIONS**

---

- Read this guide carefully and keep it for future reference.
- Follow all instructions for safe use of the product and handle with care.
- Camera is rated for outdoor use and it's weatherproof . For indoor installation, camera can be attached to ceiling directly.
- Camera is not intended for submersion in water.
- It's recommended to install under a sheltered environment .
- Attempting to disassemble the product can damage it and thus will void your warranty
- Do not point the camera directly towards the sun or a source of intense light.
- Working with DC12V power supply only. A non-regulated, non-conforming power supply may damage this product and voids your warranty.
- Make sure to install the camera in a location that can support the camera weight.
- Make sure there are no live electrical cables in the area where you plan to mount the camera.
- Periodic cleaning may be required. Use a damp cloth only. Do not use any liquid except water to clean the dome cover.

## FEATURES

---

- Mini design, beautiful appearance.
- 2pcs Array Led,IR Distance 20M-30M.
- 1/3" CMOS sensor, 2.0MP/1080P(1920\*1080),4.0MP(2688\*1520),5.0MP(2592\*1944).
- 4mm or 3X(2.8-8mm)/5X(2.7-13.5mm) optical zoom.
- support auto iris,auto focus, AWB and BLC.
- Support digital WDR function.
- Can view and control the image via IE browser and Client software
- AdoptH.265/H.264 high profile dual encoding ;
- WEB configure, real time recording, transmission and playback, download,free client software supported,SDK for customer software development.
- Support multi-protocols:IPv4,HTTP,HTTPS,Qos,FTP,SMTP,UPnP,SNMP, DNS,DDNS,NTP,RTSP,RTP,TCP/IP,DHCP,PPPoE
- Support ONVIF protocol.
- 355° horizontal rotation, 90° vertical range, control speed 70°/s.
- 254 presets,1 patrol tracking routes, residence time can be set.
- 1 left and right limit scan,1 auto level scan.
- Support power off memory function.
- Protection grade IP66.

## SPECIFICATIONS

Parameters		Specifications
Camera	Sensor	1/3" CMOS
	Pixels	1920*1080/2.0MP;2688*1520/ 4.0MP;2592*1944/5.0MP
	Zoom	4mm or 3x/5x Optical Zoom
	Focal length	4mm/2.8~8mm/2.7-13.5mm
	IR Distance	20M-30M
	Day & Night	Auto / Day / Night (ICR)
	Focus	Auto / Manual / SemiAuto
	DNR	Low / Middle /High/Off
	Video	1080p/4MP/5MP,H.265/H.264
Pan/Tilt	Horizontal	355° Horizontal rotation
	Horizontal	0.5~70°/ sec
	Vertical	0-90°
	Preset	254 Preset
	Tour	Supports 16 presets
	Other scan	Limit scan/Auto scan
General	Other	Power Up Action etc.
	Communica	RJ45, IP control
	Protocol	ONVIF
	Power	DC 12V/Current: 1A(MAX)
	Protection	IP66
	Appearance	White,aluminum alloy (ADC)
	Dimensions	132*132*115 mm
	Weight	around 650g

- Product specifications may be updated without notice.

## **INSTALLATION**

---

### **• Ceiling mount**

1. Drill a hole on ceiling, ensure camera cable can pass through;
2. Install the middle fast mounting plate to ceiling firmly;
3. Screw in the 3 flat head screws to camera base and pass the rear cable through the hole;
4. Align camera base to the fast mounting plate, clockwise rotating to fasten it.as right shown follow:

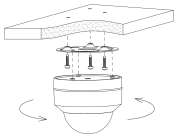

### **• Wall mount**

Use the screws to secure the wall bracket and the middle fast mounting plate.Align camera base to the fast mounting plate, clockwise rotating to fasten it.as shown follow:

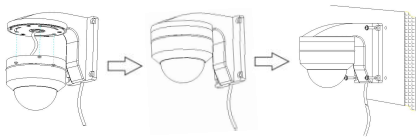

## **CHECK POINTS BEFORE OPERATION**

- Before power applied, please check the power adapter voltage
- Whether the net cable is OK and the wiring is correct

## **CONNECTION & OPERATION**

---

### **Rear cable:DC12V INPUT/AUDIO IN/RJ45**

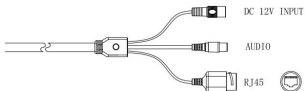

### **PAN/TILT control**

- Press Up/Down/Left/Right to control rotation.
- Press WIDE/TELE to control ZOOM.

## **OPERATION**

---

### **Login to the PTZ dome player using IE**

- Before you login, make sure the computer IP and the MINI PTZ dome IP are in the same segment. Note: The computer IP and camera IP cannot be the same.
- After the camera is powered on normally, connect the MINI PTZ dome and the computer within the LAN, enter the camera IP with In IE browser, fill in the user name and password correctly and login to the MINI PTZ dome operation interface.

The factory default IP address: 192.168.0.123 , subnet mask: 255.255.255.0 ,gateway: 192.168.0.1 ;When equipment factory, user:admin, password:123456.

## **Login to the PTZ dome player using Client**

- Before you login, make sure the computer IP and the MINI PTZ dome IP are in the same segment. Note: The computer IP and camera IP cannot be the same.
- After the camera is powered on normally, connect the camera and the computer within the LAN and turn on client software, enter the client user name and password to login the client operation interface.

## **NVR connection control IP PTZ dome**

- NVR should support ONVIF connect when using camera network control function.
- Before you login, make sure the computer IP and the MINI PTZ dome IP are in the same segment.
- Specific connection operation, please refer to the NVR operation instructions.

## **Preset operation:**

Call Preset [115]: run tour 1-16 presets scanning.

Call Preset [120]: run the lever of auto scanning.

Set Preset [94]: The PTZ recalibration.

Set Preset [93]: Clear the all presets.

Call Preset [93]: Reset factory defaults.

## ACCESSORIES & DIMENSION

---



Mini camera



Manual



Wall bracket  
(optional accessories)



Screw pack

## DIMENSION

---

Unit(mm)

Ceiling type installation dimension

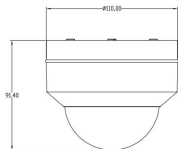

Wall installation dimension

